

total living solutions

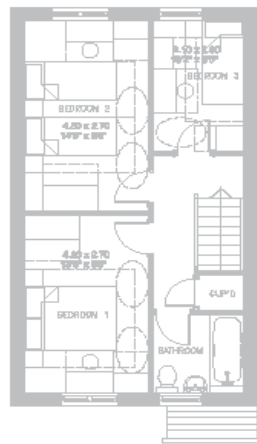

The Ashworth (Plots 18-26 inclusive)
Floor Area:
Living Accommodation = 84.50 m². (908 ft²)

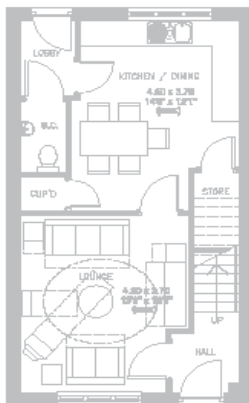

PLANS FOR GUIDANCE ONLY: Skipton Properties Limited policy is one of continuous development and improvement. Final layout and dimensions may differ. © This drawing is copyright of Skipton Properties Limited

Ground Floor Plan	First Floor Plan	Front Elevation (North)	Rear Elevation (South)
-------------------	------------------	-------------------------	------------------------

PHASE II PLOTS NOW AVAILABLE!
3 BEDROOM, 2 STOREY TRADITIONAL MEWS HOMES

PRICES FROM £139,950
(WITH HOMEBUY DIRECT YOU ONLY PAY £97,965!)

**PLOT 18 AVAILABLE TO VIEW
INTERNALLY FROM
SATURDAY 14TH NOVEMBER**

SALES CENTRE OPEN THURSDAY TO MONDAY 11AM TO 6PM
01706 839702 www.skiptonproperties.com